



**D E S C R I P T I O N**

A BOATHOUSE WITH TIGHT LIVING QUARTERS: AN EFFICIENT LAYOUT WITH OPPORTUNITIES TO PLACE UP TO SIX BEDS, HATCH AND LADDER ACCESS BETWEEN FLOORS AS WELL AS EXTERIOR STAIRS.



**A R E A C A L C U L A T I O N S**

FIRST FLOOR CONDITIONED

176 SQ FT

SECOND FLOOR CONDITIONED

400 SQ FT

LOFT FLOOR CONDITIONED

236 SQ FT

TOTAL CONDITIONED

812 SQ FT

FIRST FLOOR UNDER ROOF

658 SQ FT

SECOND FLOOR UNDER ROOF

619 SQ FT

LOFT FLOOR UNDER ROOF

236 SQ FT

TOTAL UNDER ROOF

1513 SQ FT

**H I G H L I G H T S**

- FISHING DOCK ▪ SINGLE-FAMILY
- EFFICIENT ▪ PORCH ▪ BOATHOUSE
- ONE BOAT SLIP ▪ 1.5 BATHROOM
- THREE LOFT ▪ DECK ▪ 1 BEDROOM

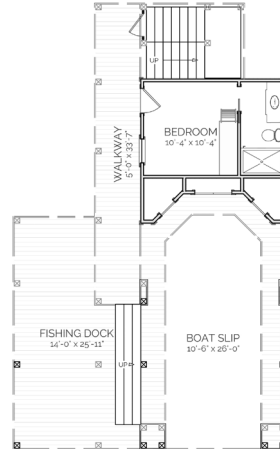

FIRST FLOOR PLAN



SECOND FLOOR PLAN



LOFT FLOOR PLAN

# JASPER

## BOATHOUSE

THIS IS PROPERTY OF LAKE + LAND STUDIO, LLC. THIS IS NOT A CONSTRUCTION DOCUMENT AND MAY NOT BE USED OR REPRODUCED WITHOUT THE PERMISSION OF LAKE + LAND STUDIO, LLC.

**LAKE + LAND STUDIO, LLC**

HATTIESBURG, MS 39402

601.336.8114

WWW.LAKEANDLANDSTUDIO.COM